

NOTES

CHECK AND CONFIRM ALL EXISTING LEVELS ON SITE PRIOR TO COMMENCING ANY WORKS. REPORT ANY DISCREPANCIES OR ERRORS TO THE ARCHITECT PRIOR TO PROCEEDING AND SEEK AN INSTRUCTION.

BUILDER SHALL VERIFY ALL DIMENSIONS ON SITE PRIOR TO COMMENCEMENT OF THE PRODUCTION OF ANY SHOP DRAWINGS OR THE MANUFACTURE OF ANY ELEMENTS AND REPORT ANY DISCREPANCIES TO THE ARCHITECT BEFORE PROCEEDING AND SEEK AN INSTRUCTION.

ALL WORKMANSHIP AND MATERIALS TO BE IN ACCORDANCE WITH THE LATEST RELEVANT SAA CODES, BUILDING REGULATIONS AND BUILDING CODE OF AUSTRALIA.

DO NOT SCALE DRAWINGS.

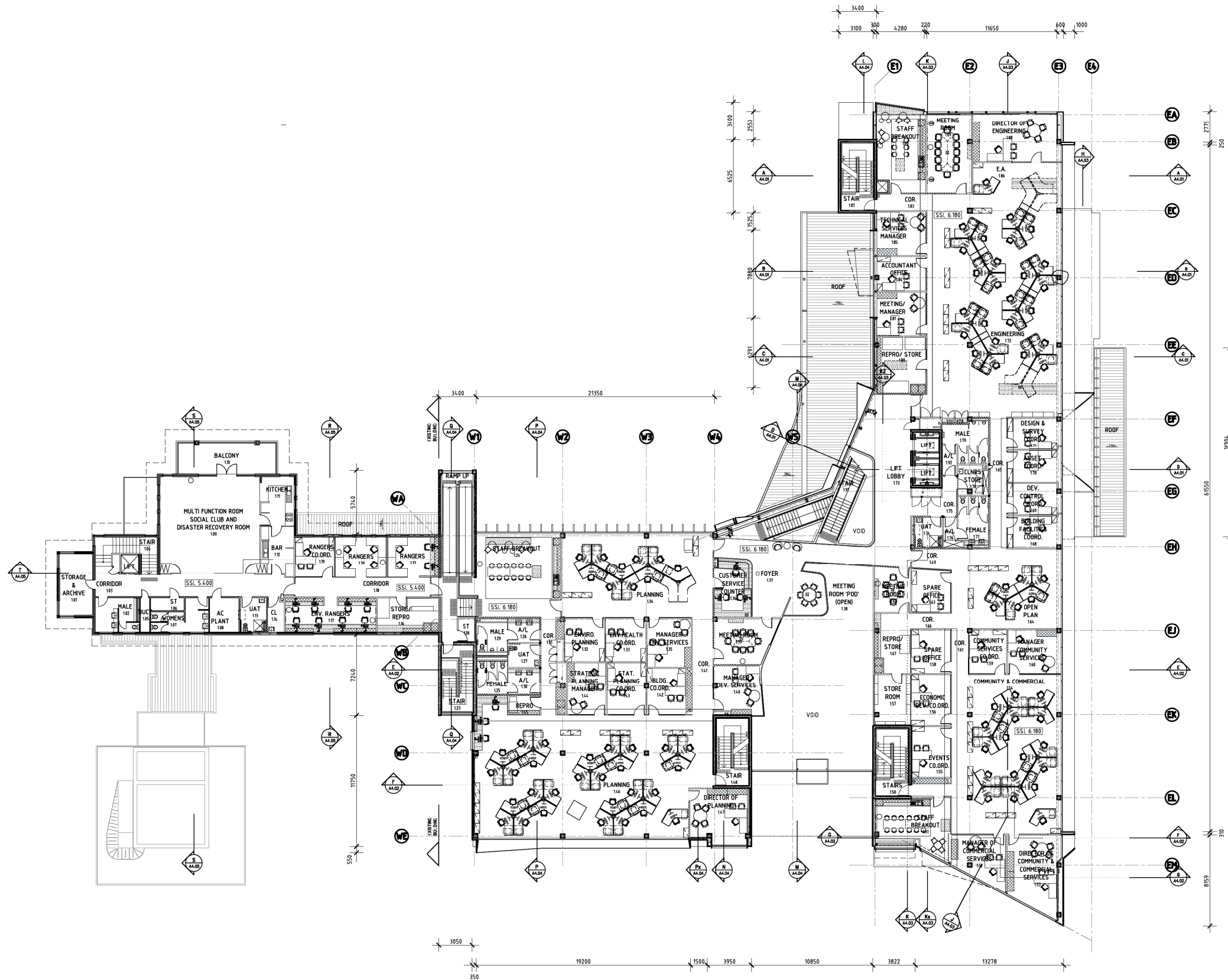

0	ISSUED FOR TENDER	05/08/15	CJ
REV	DETAILS	DATE	BY

mcg architects pty ltd
 ABN: 48 124 937 248
 the stage, old railway institute building
 62 wittenoom street, bunbury, w.a. 6230
 tel (08) 97916993 fax (08) 97918993
 e-mail reception@mcgarchitects.com.au
 working in association with
JCY architects and urban designers

CLIENT
CITY OF BUSSELTON

PROJECT TITLE
CIVIC & ADMINISTRATION CENTER
2 SOUTHERN DRIVE
BUSSELTON

DRAWING TITLE
FIRST FLOOR PLAN

DESIGN MCG/JCY	DATE 13/06/14
DRAWN HD	SCALE 1:200
COPYRIGHT THIS DRAWING IS AND SHALL REMAIN JOINT THE PROPERTY OF "mcg architects pty ltd & Jones Coulter Young Pty Ltd" AND MAY ONLY BE USED FOR THE PURPOSE FOR WHICH IT WAS COMMISSIONED AND MAY NOT BE COPIED, REPRODUCED OR DISTRIBUTED WITHOUT WRITTEN PERMISSION OF THE OWNER	PROJECT NUMBER MCG1313/JCY1310
DRAWING NUMBER A02.01	REV 0

