

08.03 typical trailhead layout

As locations where trail users will be stationary, the trailheads are the most appropriate place to provide cultural heritage interpretation and deliver detailed content.

This will be achieved through several interpretive elements which, together with functional facilities, form a typical trailhead layout to be implemented at each siding. The suite of interpretive elements will share a common language, e.g. through materiality, such that visitors can identify the interpretive overlay and perceive this as a unified experience as they journey along the trail.

The diagram above illustrates the typical layout (Yallingup Siding is shown), incorporating the following elements:

- **Interpretive box signage** delivering both general and detailed content with text and images (described in further detail below).
- **Trailhead entry signage** bearing the siding name, to be located where the reserve increases in width to form the siding.
- **Trailhead name signage** located centrally within the siding, to be read alongside other interpretive elements and on approach from carparks. Low level signage, sometimes placed beside platform remnants.
- **Seating and shelter** with opportunities to include interpretive signage. These will be located at trailheads, with a more simple seating option located at scenic points elsewhere along the trail.



typical interpretive boxes layout at trailhead

01

02

03

04

05

06

07

08
interpretation
strategies

09

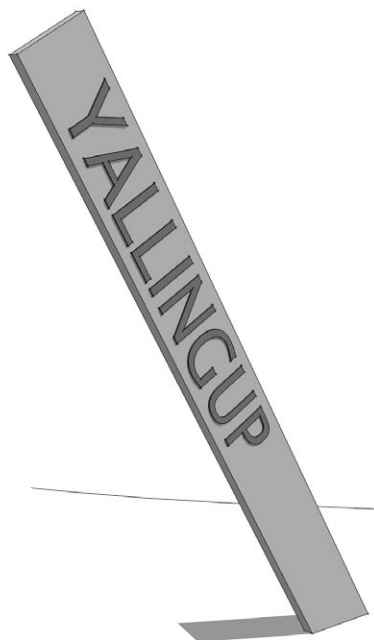

trailhead/siding entry signage



trailhead/siding name signage

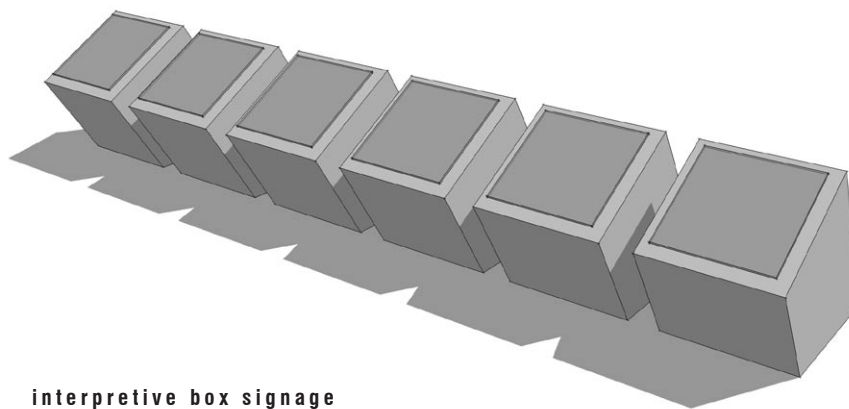

interpretive box signage

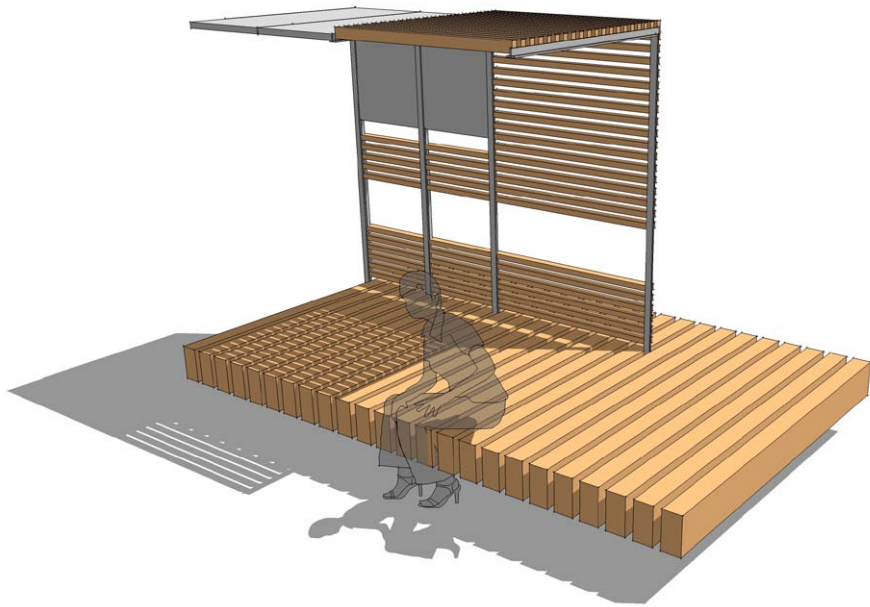

seating/shelter
at trailheads

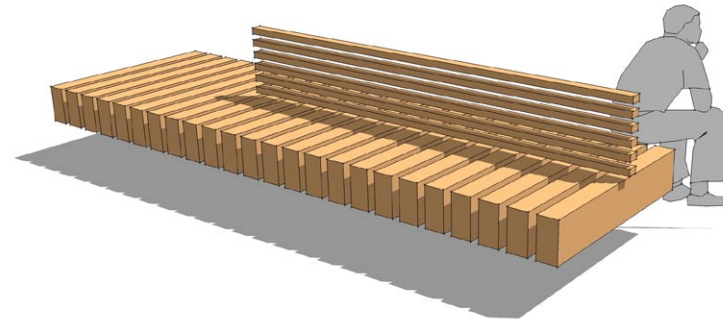

seating
at trailheads or other scenic points

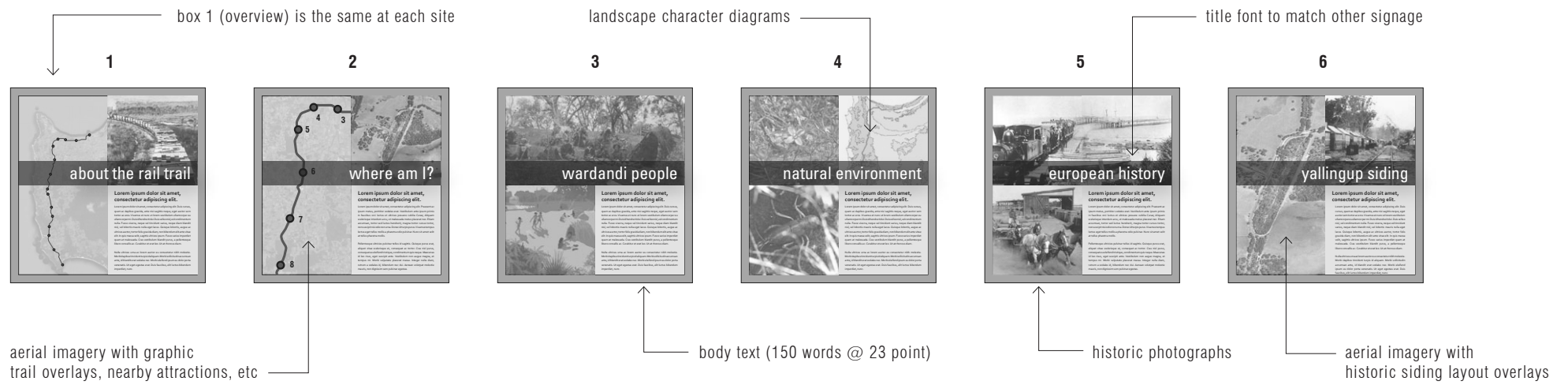

indicative graphic layout

- graphic panels divided into 'four square' layout - content distributed to squares as required
- all text/image content shown is indicative
- see outline of content below

